

Operating instructions

Electronic LED-Magnifier piggy® MAG16



Please read these instructions carefully before commissioning the system!

Explanation:

Please contact us if any accessories are missing.

The design and technical data are subject to change without prior notice.

The product names, service names etc. described in this manual are registered trademarks of the respective companies.



Warning:

- * Keep out of the reach of children.
- * Do not use or store this product or accessories in hot environments such as in cars, heaters or cooking appliances or in direct sunlight.
- * Do not use it in dusty places.
- * Do not use it in a damaged condition.
- * Do not use thinner or other organic solvents to clean the product.
- * Do not store the microscope in a place where there is a risk of falling.



Note:

The drawings used in this instruction are for reference only. Please refer to the actual product.

Precautions

1. Use only in environments between -15°C and 55°C.
2. Avoid contact with liquids.
3. Do not place the device near heat sources, open flames, or flammable or explosive gases or liquids.
4. Keep dust away from the screen and the inside of the product.
5. Avoid knocks and strong vibrations.

Product description

1

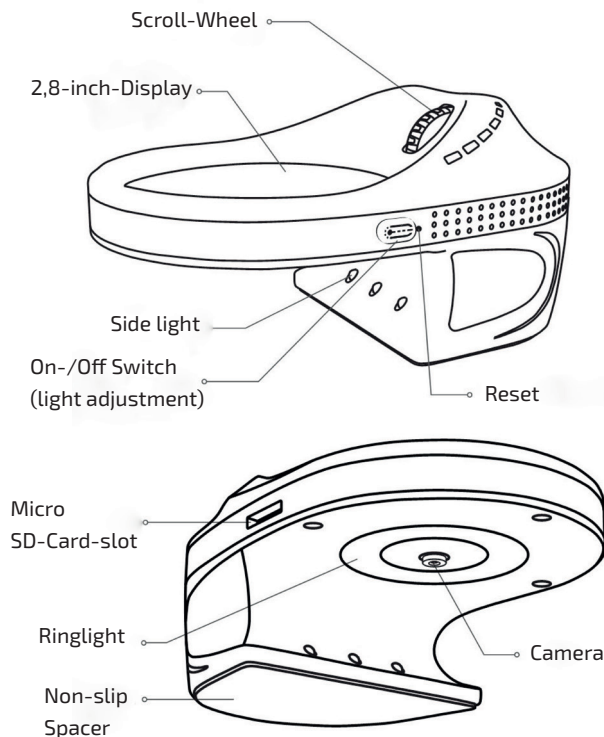

2

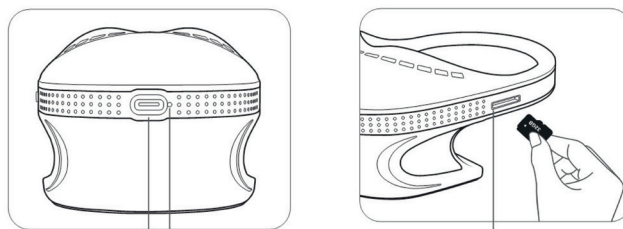

USB-C Port for charging and connection to a large monitor

Indicator light
 Red light: Charging
 Green light: Charging completed

Slot for micro SD memory card
 (max 64 GB)



Fully compatible with multiple devices, supports chargers, power banks and computers for charging visual aids.



Please do not charge it for longer than 12 hours to not impair the battery life.



Note: During charging, it is normal for the outer shell of the microscope to heat up slightly.

1. the device switches off automatically after 10 minutes of inactivity.
2. if the device freezes, use a SIM eject tool to restart it. Reset is located to the right of the power button.

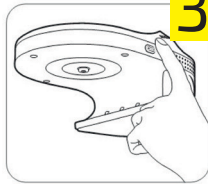
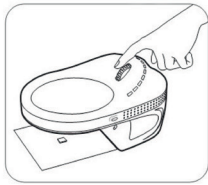
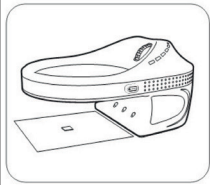

3

1. Please place the magnifier on a stable surface, press the on/off button to switch it on and place the object to be observed directly under the lens.

* Press the on/off button for approx. 3 seconds to switch on and off. This device is equipped with a fixed focus and does not require repeated focussing, making it easy to use.

2. You can select the magnification in 4 levels by turning the scroll wheel. (1X - 2X - 3X - 4X)*

Rotate up: Zoom in
Rotate down: Zoom out

Press the scroll wheel for photos, hold it down for videos.

* corresponds to: 8x-11x-13x-16x magnification

3. You can switch between the lighting modes by pressing the on/off button once:

- white light
- UV light
- white light sideways
- No light

The light intensity is set by pressing and holding the on/off switch in any light mode. To **switch off** the LED magnifier, switch to "no light"-mode and then press and hold the on/off button.

Cleaning:

It is essential to clean the screen and the casing regularly to ensure that the device remains clean and functions properly. If the screen is dirty, wipe it gently with a soft cloth.

Utilisation

6

Note:

Before using the magnifier, please insert the micro SD card to ensure the storage of photos and video files. (Supports maximum 64 GB expansion card)

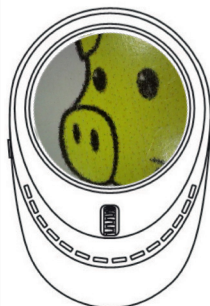

When the screen with the logo appears, press and hold the power button again to enter the date setting mode and then use the scroll wheel to change the date.

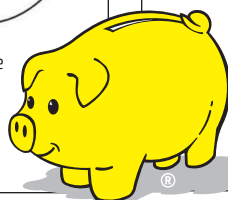

PC Connection

4

1. Use the charging cable supplied. Plug the USB-C end into the device and the USB-A end into the computer.

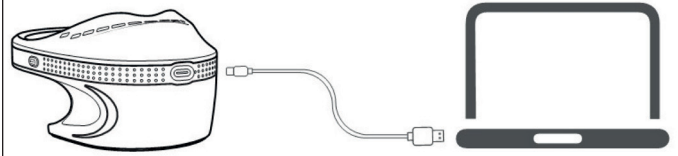

2. Once connected, a menu will appear on the magnifier's display. Select 'Mass Storage' and confirm your selection by pressing the scroll wheel again. The magnifier will then appear as a storage device on the connected computer.

3. If you select and confirm "PC Camera" in the menu, you can transfer the camera image directly to the monitor. We recommend using the Windows Camera app for this. The magnifier functions as an external USB camera.

In PC camera mode, the buttons on the magnifier are disabled. In this mode, the device must be operated via the computer.

Photo Mode

5



Click the scroll wheel to enter image lock mode. The image is frozen.

Click the scroll wheel again, the screen is unlocked and the image is automatically saved to the micro SD card.



Video mode

Press and hold the scroll wheel to switch to video mode. A red dot flashes on the screen, indicating that the video is being recorded and saved on the micro SD card. Press the scroll wheel again to stop recording.

Technical data

7

Display	Super TFT
Casing	ABS reinforced
Dimensions	130 x 87 x 64 mm
Magnification	8x - 11x - 13x -16x
Display-Ø	2,8 inch (70 mm)
Camera	1 MP (HD 1.280 x 720)
Battery	3,5 h with continuous light, 2,5 h charging time
Light source	7 white LED/4 UV LED
Input	USB-C / DC5V <2A
Weight	Approx. 160 g

The ones with the piggybank